

---

<b>MALE CONNECTORS .....</b>	<b>9-1</b>
<b>FEMALE RECEPTACLES WITH CIRCUIT BREAKERS .....</b>	<b>9-2</b>
<b>FEMALE RECEPTACLES WITHOUT CIRCUIT BREAKERS .....</b>	<b>9-3 TO 9-4</b>
<b>RECEPTACLE ACCESSORIES .....</b>	<b>9-5</b>
<b>JUNCTION BOXES .....</b>	<b>9-6</b>
<b>CABLE AND WIRE .....</b>	<b>9-7 TO 9-8</b>
<b>SEALED BEAM LAMPS .....</b>	<b>9-9 TO 9-10</b>
<b>MINIATURE LAMPS .....</b>	<b>9-11 TO 9-12</b>
<b>FLASHERS .....</b>	<b>9-12</b>
<b>WIRING HARNESSSES .....</b>	<b>9-13</b>
<b>MISCELLANEOUS INCLUDING DRY-CELL BATTERIES .....</b>	<b>9-14 TO 9-15</b>



**Single Pole Connector**  
700-17-73  
Phillips 15-335



**4-Way Connector**  
MI-BE23403  
Haldex BE23403



**6-Way Connector**  
MI-BE23603  
Haldex BE23603



**6-Way Connector with Cable Guard**  
700-17-157  
Phillips 15-630



**ISO Connector with Cable Guard**  
PH-15-830  
Phillips 15-830



**7-Way Connector**  
700-17-19  
Phillips 15-710

## 7-Way Connector with Cable Guard



700-17-22  
Phillips 15-730



MI-BE23784  
Haldex BE23784

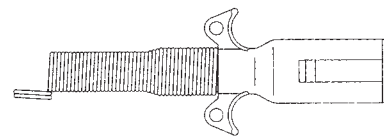

700-29-488  
Globetech GT-3007B



**7-Way Connector PermaPlug**  
PH-16-730  
Phillips 16-730

# Female Receptacles with Circuit Breakers



**7-Way Receptacle**  
with 15 Amp Circuit Breakers  
and Solid Pins  
TL-50806  
TL-50808 Cover Kit



**7-Way Receptacle**  
with 15 Amp Circuit Breakers  
and Split Pins  
29-2-89  
Haldex BE24015



**7-Way Receptacle  
Assembly**  
with 15 Amp Circuit Breakers  
and Split Pins  
700-17-26  
Haldex BE24115

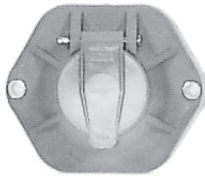

**7-Way Receptacle**  
with 20 Amp Circuit Breakers  
and Solid Pins  
TL-50864  
TL-50875 Cover Kit



**7-Way Receptacle**  
with 20 Amp Circuit Breakers  
and Split Pins  
MI-BE24020  
Haldex BE24020

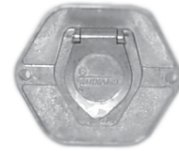

**7-Way Receptacle  
Assembly**  
with 20 Amp Circuit Breakers  
and Split Pins  
29-2-89  
Haldex BE24015

**7-Way Receptacle**  
with 20 Amp Circuit Breakers and Split Pins

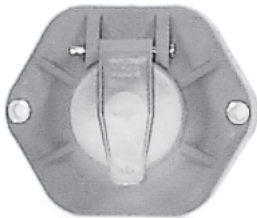

TL-50865  
TL-50875 Cover Kit



29-2-67  
Phillips 15-762



**7-Way Receptacle  
Assembly**  
with 20 Amp Circuit Breakers  
and Split Pins  
700-29-479  
Phillips 15-7629

**7-Way Receptacle**  
with 30 Amp Circuit Breakers and Split Pins

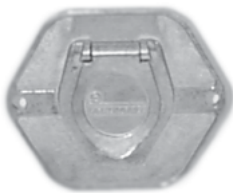

MI-BE24030  
Haldex BE24030



700-17-101  
Phillips 15-763



**Single Pole Receptacle**  
700-17-72  
Phillips 15-320



**ISO Receptacle**  
PH-16-826  
Phillips 16-826



**ISO Receptacle with Ring Terminals**  
PH-16-822  
Phillips 16-822



**4-Way Receptacle with Split Pins**  
MI-BE23402  
Hallex BE23402



**6-Way Receptacle with Split Pins**  
MI-BE23602  
Hallex BE23602



**7-Way Receptacle with Bullet Terminals Sta-Dry**  
PH-16-724  
Phillips 16-724

**7-Way Receptacle with Solid Pins**

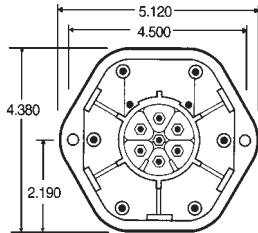

TL-50860

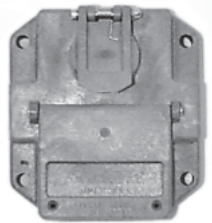

TL-50805  
TL-50808 Cover Kit



**7-Way Receptacle (Right Angle) with Solid Pins**  
TL-50822  
TL-50808 Cover Kit

**7-Way Receptacle with Split Pins**

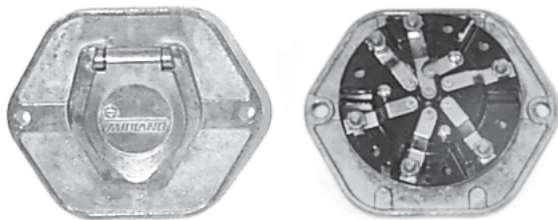

MI-BE24000  
Hallex BE24000



MI-BE24001  
Hallex BE24001

# Female Receptacles without Circuit Breakers



## 7-Way Receptacle with Split Pins

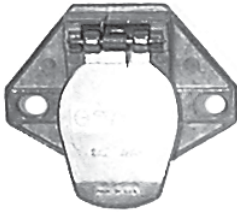

**MI-BE23703**  
Haldex BE23703



**700-29-489**  
Globetech GT-3227



**29-2-121**  
Phillips 15-760

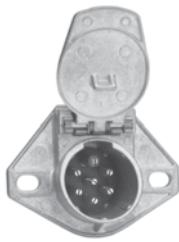

**PH-15-720**  
Phillips 15-720

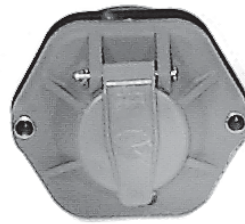

**29-A2-47**  
Tramec 38373  
700-29-464 Cover Kit



### 7-Way Receptacle Assembly with Split Pins

**29-A2-46**  
Tramec 38383B  
700-29-464 Cover Kit



**7-Way Receptacle  
3-Hole Mount  
with Terminal Kit**  
GR-87240



**Adapter Housing**  
700-17-35  
Phillips 15-769



**Receptacle Mounting Box**  
GR-43684



**Receptacle Mounting Box (Dual)**  
PH-16-777  
Phillips 16-777



**Nose Box Housing (Bottom Access)**  
TL-50882



**Nose Box Housing (Rear Access)**  
TL-50883



**Replacement Cover Kit**  
MI-BQ24002  
Haldex BQ24002

## Receptacle Mounting Plate

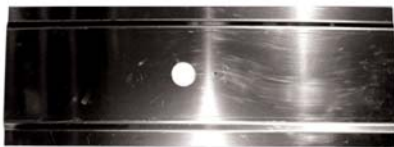

29-4-475  
Aluminum



1029-4-158  
Aluminum

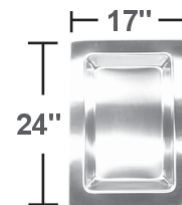

**Recessed Mounting Pan**  
9511-16-262  
Penz P80-197; Aluminum



**7-Pin Plug and Socket Brush**  
700-29-478  
Phillips 4-121



**Circuit Breaker**  
700-17-124 20 Amp  
700-17-126 30 Amp

# Junction Boxes

## 7-Terminal Box



**Distribution Module  
4-Outlet**  
TL-87804

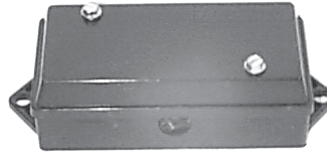

**29-26-50**  
Uni-Bond JB0700



**700-17-58**  
Haldex BE22150



**Junction Box - Surface Mount**  
TL-50400



**Junction Box - Buckplate Mount**  
TL-50401



**Junction Box  
Hardware Kit**  
TL-50850



### Compression Fittings

Part No.	I.D.
TL-50840	3/8"
TL-50841	1/2"
TL-50842	3/4"
TL-50846	Flat Cable



**Jam Nut**  
TL-50845

Note: Black = Standard  
Green = ABS  
Yellow = ISO



## 7-Way Coiled Cables with Metal Plugs with Springs

Part No.	Color	Working Length	Conductors	Cross Reference
700-29-466	Black	12 Ft	6-12 Ga., 1-10 Ga.	Phillips 22-4321
700-29-474			6-14 Ga., 1-12 Ga.	Philatron 2812CM
700-29-465				Tramec 47A12
700-29-467		15 Ft	6-12 Ga., 1-10 Ga.	Phillips 22-4621
700-29-476			6-14 Ga., 1-12 Ga.	Philatron 2815CM
700-29-496				Tramec 47A15
700-29-498	Green		1-8 Ga., 2-10 Ga., 4-12 Ga.	Tramec 4DA17
PH-31-9623	Yellow	Phillips 31-9623		



## 7-Way Coiled Cables with Plastic Plugs

Part No.	Color	Working Length	Conductors	Cross Reference
PH-30-9620	Green	15 Ft	1-8 Ga., 2-10 Ga., 4-12 Ga.	Phillips 30-9620
700-29-483				Philatron (ABS) 2-415-CL



## Single-Pole Coiled Lift Gate Cables with Metal Plugs with Springs

Part No.	Color	Working Length	Conductors	Cross Reference
700-29-470	Green	12 Ft	1-4 Ga.	Phillips 23-4325
700-29-471		15 Ft		Phillips 23-4625

# Cable and Wire



## Bulk Trailer Cable

Part No.	Number of Conductors	Conductors	Length	Red	Yellow	Green	Blue	White	Black	Brown
50-26B-27	4	4-14 Ga.	100 Ft	X	X			X	X	
700-17-74	6	6-14 Ga.	100 Ft	X	X	X		X	X	X
700-17-74-500			500 Ft							
700-29-485-100	7	6-12 Ga., 1-10 Ga.	100 Ft	X	X	X	X	X	X	X
700-29-485-500			500 Ft							
700-29-486-100		6-14 Ga., 1-12 Ga.	100 Ft							
700-29-486-500			500 Ft							

## Bulk Duraflex Cable

Part No.	Number of Conductors	Conductors	Length	Red	Yellow	Green	Blue	White	Black	Brown
700-29-487-100	7	6-14 Ga., 1-12 Ga.	100	X	X	X	X	X	X	X



## Primary Wire

100-Ft Spools

12 GAUGE		14 GAUGE
Part No.	Color	Part No.
700-29-416	Red	700-29-111
700-29-417	Green	700-29-112
700-29-418	Blue	700-29-113
700-29-419	Black	700-29-114
700-29-420	Yellow	700-29-115
700-29-421	Brown	700-29-116
700-29-422	White	700-29-117

## ABS Cable

700-29-497-100

Green; 100 Ft

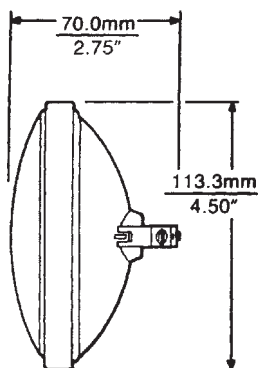

## Round PAR-36 Bulb

Part No.	Base Type	Primary Application
LB-4411	2 Screw Terminals	Tractor
LB-4415		Fog
LB-4416		Spotlamp, Signal
LB-4509		For Truck-Lite 80374

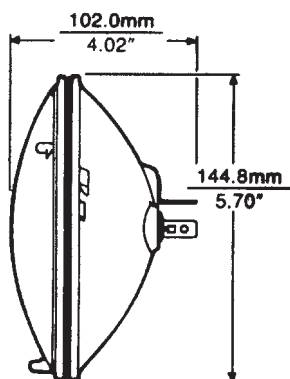

## Round PAR-46 Bulb

Part No.	Base Type	Primary Application
LB-4000	3 Contact Lugs	Auto Hi-Low Beam

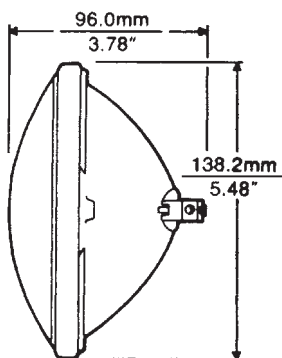

## Round PAR-46 Bulb

Part No.	Base Type	Primary Application
LB-4412	2 Screw Terminals	Fog
LB-4412A		Fog - Yellow

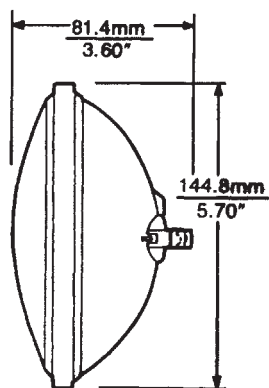

## Round PAR-46 Bulb

Part No.	Base Type	Primary Application
LB-4421	2 Slip-On Terminals	Auto/Truck Special Service
LB-4537		Aircraft Landing

# Sealed Beam Lamps

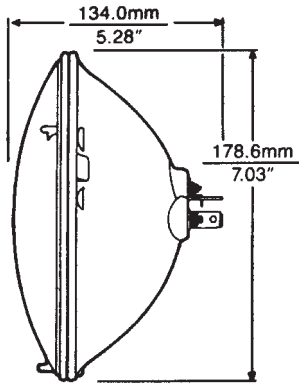

## Round PAR-56 Bulb

Part No.	Base Type	Primary Application
LB-6014	3 Contact Lugs	Auto Hi-Low Beam
LB-6015		Auto/Truck Hi-Low Beam
LB-H6024		Auto Hi-Low Beam

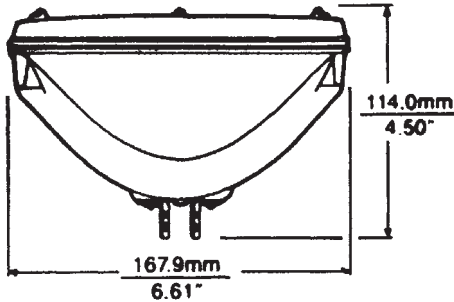

## Rectangular 100 x 165 Bulb

Part No.	Base Type	Primary Application
LB-H4651	2 Contact Lugs	Auto Hi Beam

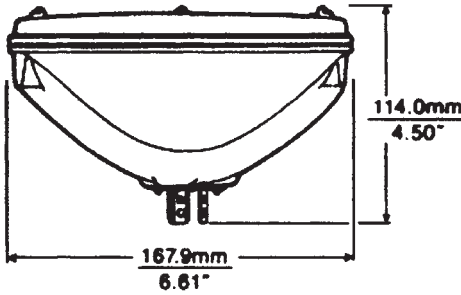

## Rectangular 100 X 165 Bulb

Part No.	Base Type	Primary Application
LB-4652	3 Contact Lugs	Auto Low Beam
LB-H4656		

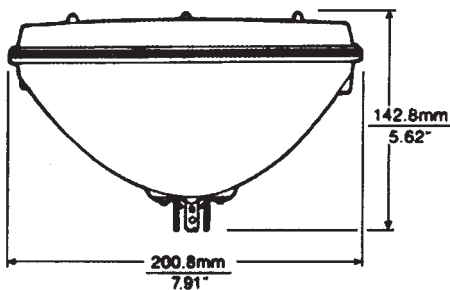

## Rectangular 142 X 200 Bulb

Part No.	Base Type	Primary Application
LB-6052	3 Contact Lugs	Auto Hi-Low Beam
LB-H6054		

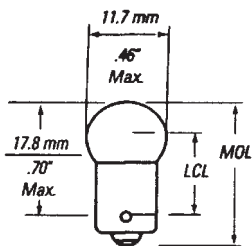

**LB-53T**

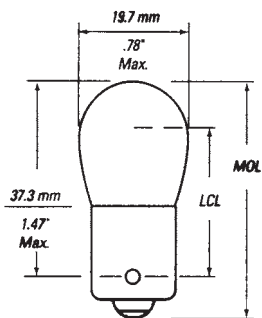

**LB-198T**

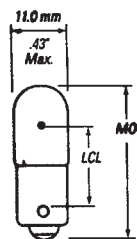

**LB-1889T**  
**LB-1893T**  
**LB-1891T**

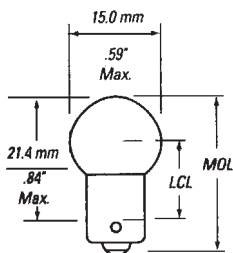

**LB-57T**  
**LB-293T**  
**LB-1895T**

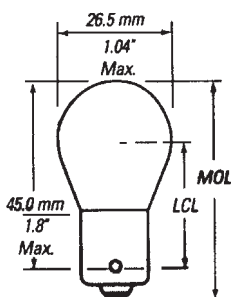

**LB-199T**

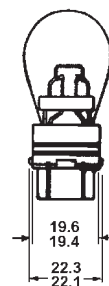

**LB-3156T**

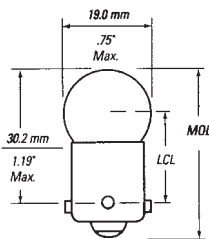

**LB-67T**  
**LB-89T**  
**LB-97T**  
**LB-1155T**

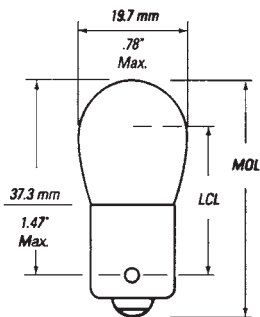

**LB-1003T**

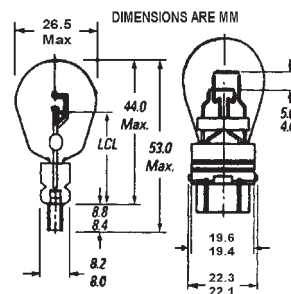

**LB-3157T**  
**LB-3157NAT** Amber

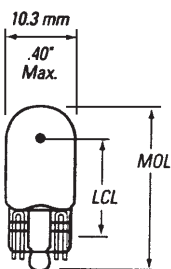

**LB-161T**

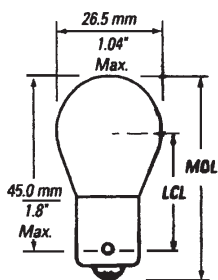

**LB-1141T**  
**LB-1156T**

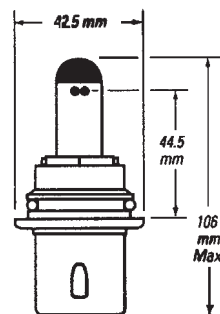

**LB-9004**

# Miniature Lamps

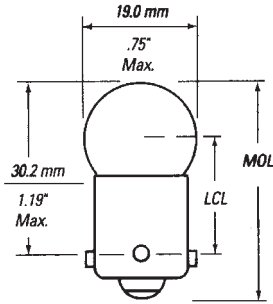

**LB-194T**

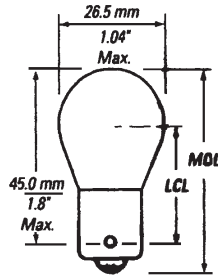

**LB-1157T**  
**LB-1157NAT** Amber

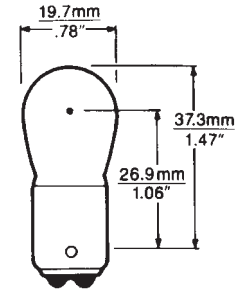

**LB-1004T**

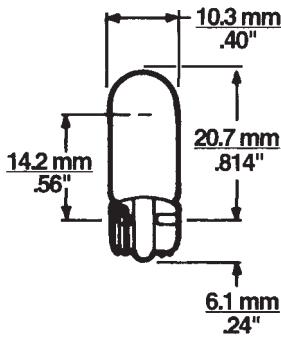

**LB-168T**

## Flashers



**Truck-Lite**  
**Ultra Flash**  
**TL-97232**

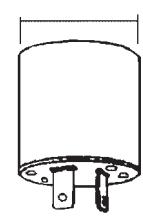

1<sup>3</sup>/<sub>8</sub>"  
Dia.

**Grote**  
**10-Lamp Flasher**  
**GR-44810**  
12 Volt, 2-Pin

## 12-Lamp Flashers

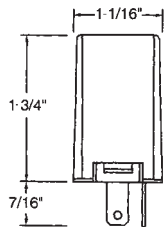

**Truck-Lite**  
**TL-172**  
12 Volt, 2-Pin



**Grote**  
**GR-44530**  
12 Volt, 2-Pin



**Grote**  
**GR-44540**  
12 Volt, 3-Pin

## Trailmobile Main Harness

**29-3-451A-530-1A**  
53' Trailer; 7-Wire

**TL-88794-0720**  
53' Trailer; 6-Wire

**TL-50957**  
Converter Dolly

**Trailmobile  
Marker Light  
Adapter**  
29-3-405

**Trailmobile  
ABS  
Power Harness**  
TL-52104-1576

**Trailmobile  
ABS  
Power Cable**  
29-3-484

## Trailmobile Rear Sill Harness

**29-3-398**  
6-Wire

**TL-88547**

**Trailmobile  
Upper Rear  
Triple Harness**  
29-3-452-48  
48 Inches

**Adapter for  
3-Light System**  
29-3-368  
Used with  
Trailmobile 6-Wire Harness

**Trailmobile  
License Light  
Harness**  
29-3-393-12

# Miscellaneous



**Toggle Switch**  
29-30-16  
Cup-Mounted;  
Cole Hersee 5543

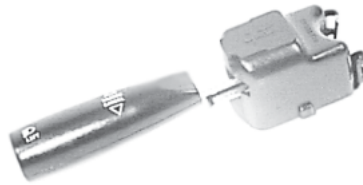

**Turn Signal Switch**  
GR-48282



**Push-Pull Switch**  
SS-102

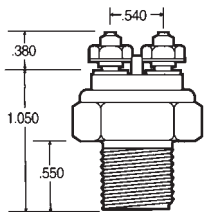

**Stop Light Switch**  
TL-50899



**ABS Accessory Switch**  
700-17-490  
Tramec 38041



**Receptacle Boot**  
TL-50890  
Rubber



**Circuit Tester**  
TL-97101

## Frame Clamps



Part No.	Tube Size	Mounting Hole Size
700-99-409	1/4"	1/4"
700-99-410	3/8"	
700-99-411	1/2"	
700-99-412	3/4"	
700-99-413	1"	

## Nylon Cable Ties

Part No.	Length
700-99-266	4"
700-99-267	6"
700-99-268	8-1/2"
700-99-269	11-3/4"
700-99-270	14-1/2"
700-99-271	15-1/2"

## Rubber Grommets

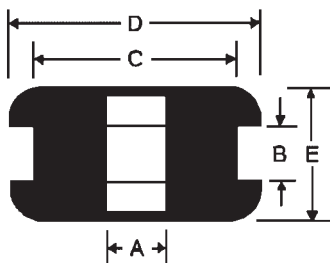

Part No.	A	B	C	D	E	TYPE
700-50-55	0.6875	0.1875	1	1.3125	0.50	Open
50-14-27	0.875	0.1875	1.25	1.625	0.5625	
50-14-125	0.9375	0.25	1.25	1.50	0.50	Closed
50-14-39	1.0625	0.125	1.25	1.75	0.4375	Open

## DURACELL BATTERIES



### **AA**

**700-99-502-AA-4PK**

4-Pack

### **AAA**

**700-99-502-AAA-4PK**

4-Pack

### **C**

**700-99-502-C-2PK**

2-Pack

### **D**

**700-99-502-D-2PK**

2-Pack

### **9-Volt**

**700-99-502-9V-1PK**

1-Pack